



# GHURA

Guam Housing and Urban Renewal Authority  
Aturidat Ginima' Yan Rinueban Siudad Guahan  
117 Bien Venida Avenue, Sinajana, GU 96910  
Phone: (671) 477-9851 Fax: (671) 300-7565 TTY: (671) 472-3701  
Website: [www.ghura.org](http://www.ghura.org)



## UNIT FOR RENT FORM SUBMISSION

This form is posted in GHURA's Units for Rent Binder. Rental information is posted on [www.ghura.org](http://www.ghura.org) within 3 business days.

DATE: Jan 06, 2026 GHURA RECEIVED: \_\_\_\_\_

### LANDLORD INFORMATION

NAME: Yen-San Ou Huang/Jenny PHONE #: (671) 482-2100

EMAIL: jenny@guampcs.com ALTERNATE #: (\_\_\_\_\_) \_\_\_\_\_

### ABOUT THE UNIT

RENT PER MONTH: \$ 2200 BEDS: 3 BATHS: 2 SQ FT: 1000 YR BUILT: 1982

DATE UNIT AVAILABLE: Jan 15 2026  
MONTH DAY YEAR

UNIT ADDRESS: 149 West Espiritu G. Tamuning GU 96913  
STREET ADDRESS VILLAGE ZIP CODE

### TYPE OF UNIT:

- |  |   |
|--|---|
| <input type="checkbox"/> Single House Detached                 | <input type="checkbox"/> Low Rise Apartment (3-4 stories) |
| <input checked="" type="checkbox"/> Duplex                     | <input type="checkbox"/> High Rise Apartment (5+ stories) |
| <input type="checkbox"/> Row House or Town House (1-2 stories) | <input type="checkbox"/> Other: _____                     |

### BASIC APPLIANCES PROVIDED BY LANDLORD:

- |  |  |
|--|--|
| <input checked="" type="checkbox"/> Refrigerator     | <input checked="" type="checkbox"/> Air Conditioner (not required) |
| <input checked="" type="checkbox"/> Stovetop / Range | <input checked="" type="checkbox"/> Washer / Dryer (not required)  |
| <input checked="" type="checkbox"/> Water Heater     | <input type="checkbox"/> Other: _____                              |

### UTILITIES PAID BY LANDLORD:

- |  |  |
|--|--|
| <input type="checkbox"/> No Utilities (paid by tenant) | <input checked="" type="checkbox"/> Some Utilities (list utilities covered by landlord): |
| <input type="checkbox"/> All Utilities                 | <u>Water/sewer</u>   |

### ADA (AMERICANS WITH DISABILITY ACT) AMENITIES:

- |  |                                       |
|--|---------------------------------------|
| <input type="checkbox"/> Wheelchair Accessible       | <input type="checkbox"/> Other: _____ |
| <input type="checkbox"/> Sight Impairment Accessible |                                       |

SEE UNIT MAP ON BACK

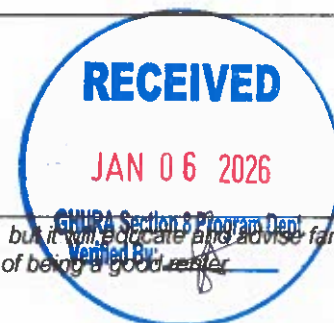

GHURA will not steer families to select a certain unit as it is prohibited under the Section 8 Program, but it will educate and advise families on how to select a suitable unit and how to be a good tenant through basic practices of being a good renter.

# UNIT LOCATION MAP

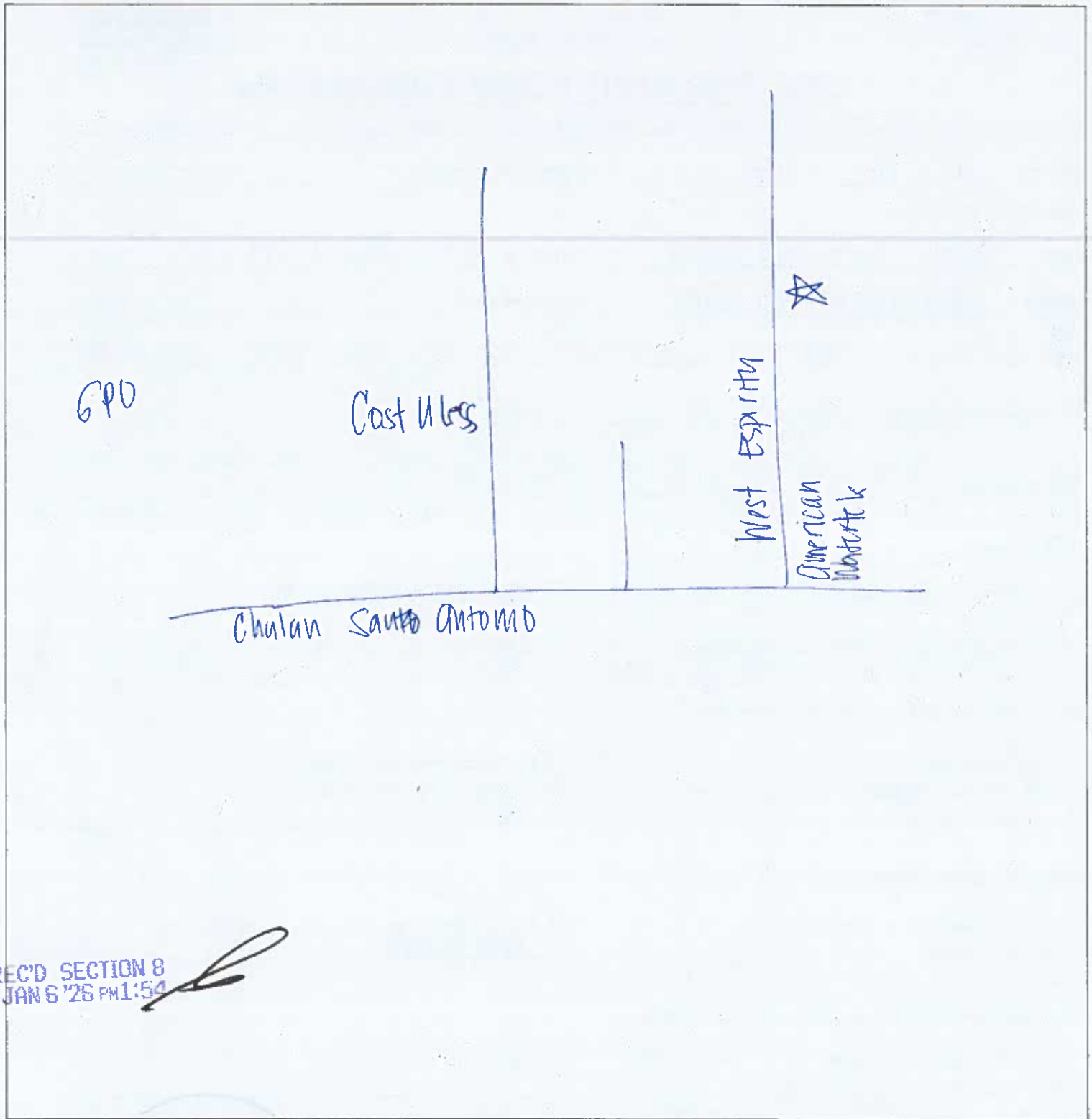

REC'D SECTION 8  
JAN 6 '26 PM 1:54

*[Handwritten signature]*

GHURA will not steer families to select a certain unit as it is prohibited under the Section 8 Program, but it will educate and advise families on how to select a suitable unit and how to be a good tenant through basic practices of being a good renter.